

# Operating Instructions / Handling

Before using, read carefully and store in a safe location



plastics technology

## Quick Connecting Fluid Couplings PTFE



The Fluid couplings are for a pressureless designed connections. The piping must be pressureless during disconnecting.

### Safety precautions

The built-in spring shall not exceed the max. use duration of 3 years. The seals are checked for function regularly and these shouldn't exceed max. use duration of 1 year. Depending on chemistry can the interval be shorter.

### Commissioning

During initial commissioning, the first litres of product are to be used as a washing chemical.

### Safety labelling

Standard OSHA Regulations for Safety at the workplace for handling of dangerous and poisonous chemicals apply. Designated protective clothing and safety gear must be worn at all times.

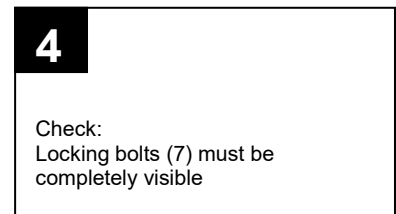
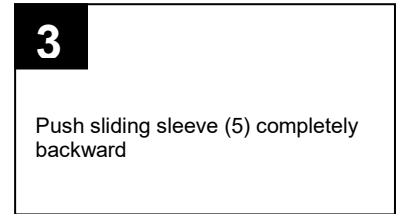
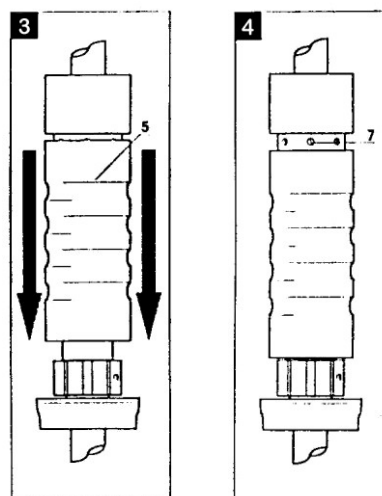
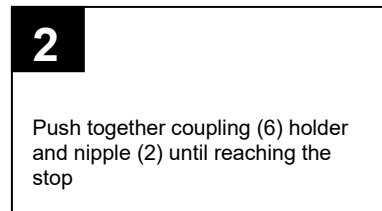
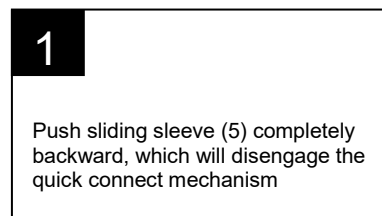
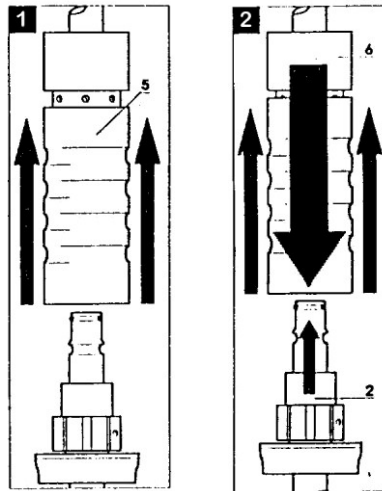

### Liability

AS Strömungstechnik GmbH can accept no liability for errors or damages that result from improper handling of the QC container closures. Improper handling includes, in particular, failure to observe the operating instructions. Testing the chemical resistance of the dip tubes and their operational life is the responsibility of the customer. In the interest of the further development of as products, we reserve the right to make design changes.

AS Strömungstechnik GmbH | hagäckerstr. 28 | 73760 ostfildern | germany  
tel.: +49 (0) 7 11 220548-0 | fax +49 (0) 711 220548-29 | e-mail: info@asstroemungstechnik.de  
www.asstroemungstechnik.de | DIN-certified ISO 9001:2015 | district court stuttgart HRB 224744  
managing director: andreas szeteli, michael szeteli, thomas raißer