

# QC-System for ISO Container

U.S. Patents 6,357,494; 9,580,197



## AS QC ISO Coupler with Breakaway Quick-Closing Device

### Features:

- Breakaway quick-closing device.
- Built-in check-valve assures spill-free connection and disconnection.
- Quick and easy coupling CCB ( clean coupling booth).
- Safe and clean handling of chemicals in a close loop system (chemical and N2).
- Flanges available for different standards (e.g. ANSI, DIN, JIS) or NPT threads, other types on request
- Qualified for high-purity liquids.
- Highly elastic, long lasting spring.
- Optional: with sampling port.

### Technical Specifications:

<b>Material</b>	<ul style="list-style-type: none"> <li>• PCTFE</li> <li>• Optional: PVDF</li> </ul>
<b>Check valve (RV)</b>	• Opening pressure 10 KPa
<b>O-ring standard</b>	• Perfluorelastomer Kalrez®
<b>Flow-rate</b>	• See flow chart
<b>Chemical connection</b>	• DN40
<b>Vent connection</b>	• DN25
<b>Tank container</b>	• Female part
<b>CCB, plant</b>	• Male part

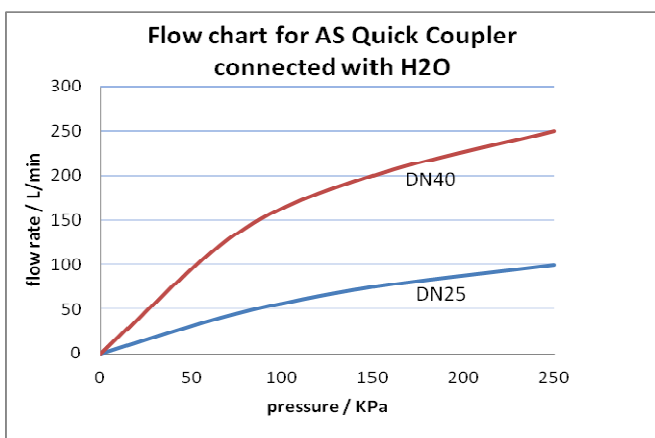
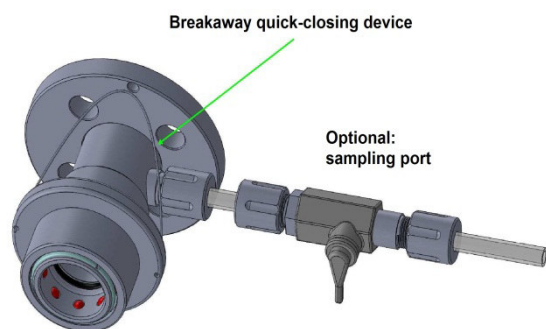

#### Remarks:

- All wetted components are PCTFE, (optional: PVDF), with o-ring seals of Kalrez®.
- Kalrez® is a registered trademark of DuPont Co.

AS Strömungstechnik GmbH | elly-beinhorn-str. 7 | 73760 ostfildern | germany  
 tel.: +49 (0) 7 11 220548-0 | fax +49 (0) 711 220548-29 | e-mail info@asstroemungstechnik.de  
 www.asstroemungstechnik.de | DIN-certified ISO 9001:2015 | district court Stuttgart HRB 224744  
 managing director: andreas szeteli, michael szeteli, thomas raißer

