

Universal Wrench for Dip Tubes QC-2, QC-3, G-series



Application:

Universal wrench for opening, closing and mounting of dip tubes and screw plugs.

Technical Specifications:

- Material: PE, PVDF, electrically conductive (CD)
- QC-2 dip tube, closure stopper 3/4" and QC 42 x 2, screw plug S62
- QC-3 dip tube, closure stopper 53
- GT2 dip tube, closure stopper 1"
- 24mm dia. hexagonal key to connect e.g. Torque Wrench



system	material	order No.
QC-2	PE	RDH-79003
QC-2	PVDF	RDH-79005
QC-2	electrically conductive (CD)	RDH-79003-CD
G-series	PE	RDH-79009
G-series	PVDF	RDH-79010
QC-3	PE	RDH-79007-PE
QC-3	PVDF	RDH-79007-PVDF

Dimensions / Tightening torques:

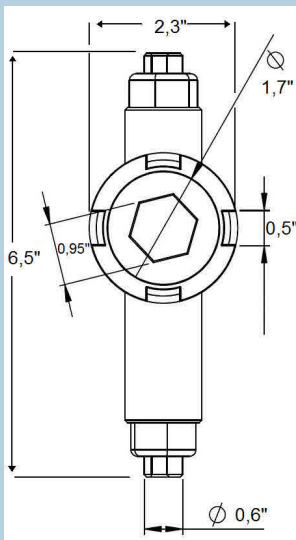

packing type	steel-plastic combination	PE-bung barrel				combination IBC		
	packing code UN	1H1				31HA1 / 31HH1		
Thread (BCS)	56 x 4	56 x 4	62 x 5	70 x 6	56 x 4	62 x 5	70 x 6	
Torque [Nm]	25 +5	20 +5	30 +5	35 +5	20 +5	30 +5	35 +5	

For the 3/4" closure stopper (dip-tube and fitting) general 5-6 Nm

For the QC 42 x 2 closure stopper (dip-tube and fitting) general 6-8 Nm

Note:

The supplier of chemicals is responsible for safe handling of the chemical. For closing containers with QC-System dip tubes, closures or adaptors we recommend the following torques. Binding torques are verified with the container manufacturer.

AS Strömungstechnik GmbH | elly-beinhorn-str. 7 | 73760 ostfildern | germany
 tel.: +49 (0) 7 11 220548-0 | fax: +49 (0) 711 220548-29 | e-mail: info@asstroemungstechnik.de
 www.asstroemungstechnik.de | DIN-certified ISO 9001:2015 | district court Stuttgart HRB 224744
 managing director: andreas szeteli, michael szeteli, thomas raißer

